

区画丈量図

所在：丸亀市垂水町字高岸

縮尺：1/300

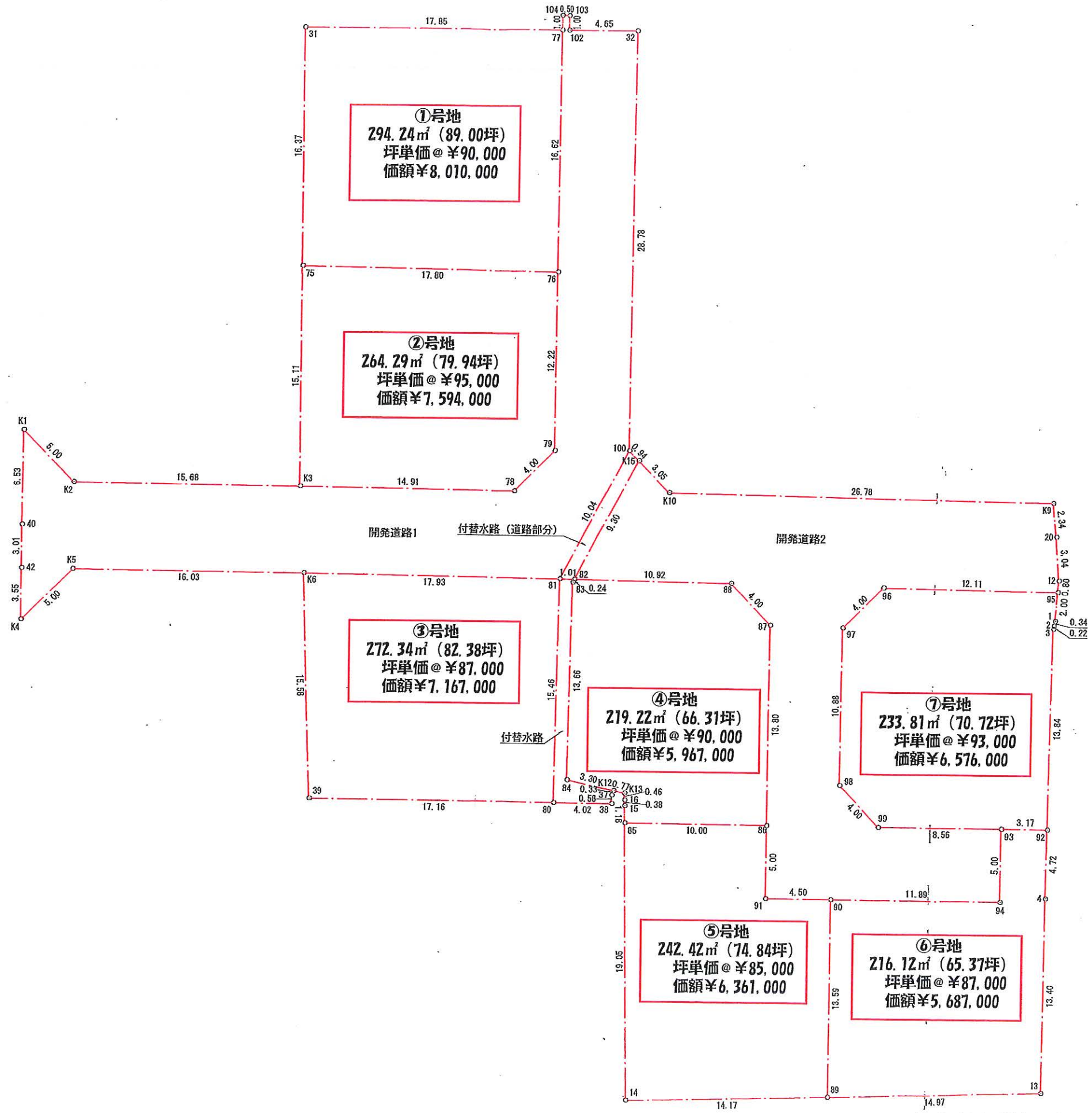
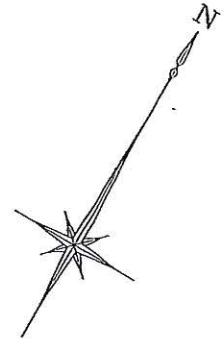

丸亀市土器町西五丁目388番地

作製者 土地家屋調査士 内海

TEL (0877) 23-5272





求積表

Table ①: Land area calculation for parcels 31, 75, 76, 77. Includes columns for NO, Xn, Yn, Yn+1-Yn-1, and Xn · (Yn+1-Yn-1). Total area is 294.24 m².

Table ②: Land area calculation for parcels 75, K3, 78, 79, 76. Includes columns for NO, Xn, Yn, Yn+1-Yn-1, and Xn · (Yn+1-Yn-1). Total area is 264.29 m².

Table ③: Land area calculation for parcels K6, 39, 80, 81. Includes columns for NO, Xn, Yn, Yn+1-Yn-1, and Xn · (Yn+1-Yn-1). Total area is 272.34 m².

Table ④: Land area calculation for parcels 82, 83, 84, K12, K13, 16, 15, 85, 86, 87, 88. Includes columns for NO, Xn, Yn, Yn+1-Yn-1, and Xn · (Yn+1-Yn-1). Total area is 219.22 m².

Table ⑤: Land area calculation for parcels 85, 14, 89, 90, 91, 86. Includes columns for NO, Xn, Yn, Yn+1-Yn-1, and Xn · (Yn+1-Yn-1). Total area is 247.42 m².

Table ⑥: Land area calculation for parcels 90, 89, 13, 4, 92, 93, 94. Includes columns for NO, Xn, Yn, Yn+1-Yn-1, and Xn · (Yn+1-Yn-1). Total area is 216.12 m².

Table ⑦: Land area calculation for parcels 92, 3, 2, 1, 95, 96, 97, 98, 99, 93. Includes columns for NO, Xn, Yn, Yn+1-Yn-1, and Xn · (Yn+1-Yn-1). Total area is 233.81 m².

Table ⑧: Land area calculation for parcels K1, 40, 42, K4, K5, K6, 81, 100, 32, 102, 103, 104, 77, 76, 79, 78, K3, K2. Includes columns for NO, Xn, Yn, Yn+1-Yn-1, and Xn · (Yn+1-Yn-1). Total area is 413.03 m².

Table ⑨: Land area calculation for parcels K15, 82, 88, 87, 86, 91, 90, 94, 93, 99, 98, 97, 96, 95, 12, 20, K9, K10. Includes columns for NO, Xn, Yn, Yn+1-Yn-1, and Xn · (Yn+1-Yn-1). Total area is 377.31 m².

Table ⑩: Land area calculation for parcels K15, 100, 81, 82. Includes columns for NO, Xn, Yn, Yn+1-Yn-1, and Xn · (Yn+1-Yn-1). Total area is 8.73 m².

Table ⑪: Land area calculation for parcels 81, 80, 38, 37, K12, 84, 83, 82. Includes columns for NO, Xn, Yn, Yn+1-Yn-1, and Xn · (Yn+1-Yn-1). Total area is 17.84 m².